

Please read this manual carefully before installation and keep it for future reference.

Wiring Control Install Manual



MRCOOL™
COMFORT MADE SIMPLE

Olympus Series
Mid-Static Duct Air Handler
(9K, 12K, 18K, 24K & 48K Models)

Please keep this manual where the operator can easily find it.
Inside you will find helpful hints on how to use and maintain your
unit properly.

For more info visit www.mrcool.com



- This manual gives detailed description of the precautions that should be brought to your attention during operation.
- In order to ensure correct service of the wired controller please read this manual carefully before using the unit.
- For convenience of future reference, keep this manual after reading it.

CONTENTS

1. SAFETY PRECAUTIONS.....	1
2. INSTALLATION ACCESSORY.....	2
3. INSTALLATION METHOD.....	4

1. SAFETY PRECAUTIONS

- Read the safety precautions carefully before installing the unit.
- Stated below are important safety issues that must be obeyed.

 WARNING	Means improper handling may lead to personal death or severe injury.
 CAUTION	Means improper handling may lead to personal injury or property loss.



WARNING

Please entrust the distributor or professionals to install the unit.

Installation by other persons may lead to imperfect installation, electric shock or re.

Adhere to this installation manual.

Improper installation may lead to electric shock or re.

Reinstallation must be performed by professionals.

Improper installation may lead to electric shock or re.

Do not uninstall the unit unless you absolutely need to.

Uninstalling multiple times may lead to abnormal operation, heating or re of the unit.

NOTE

- ① Do not install the unit in a place vulnerable to leakage of flammable gases. Once flammable gases are leaked and left around the wire controller, fire may occur.
 - ② Do not operate with wet hands or let water enter the wire controller. Otherwise, electric shock may occur.
 - ③ The wiring should adapt to the wire controller current. Otherwise, electric leakage or heating may occur and result in fire.
 - ④ The specified cables shall be applied in the wiring. No external force may be applied to the terminal. Otherwise, wire cut and heating may occur and result in fire.
-

2. INSTALLATION ACCESSORY

Select the installation location

Don't install at the place where cover with heavy oil, vapor or sulfureted gas, otherwise, this product would be deformed that would lead to system malfunction.

Preparation before installation

1. Please confirm that all the following parts you have been supply.

No.	Name	Qty.	Remarks
1	Wire controller	1	_____
2	Installation and owner's manual	1	_____
3	Screws	3	M4X20 (For Mounting on the Wall)
4	Wall plugs	3	For Mounting on the Wall
5	Screws	2	M4X25 (For Mounting on switch box)
6	Plastic screw bars	2	For fixing on switch box
7	The connective wires group	1	24AWG

2. Prepare the following assemblies on the site.

No.	Name	Qty.(embedded into wall)	Specification (only for reference)	Remarks
1	Switch box	1	_____	_____
2	Wiring Tube(Insulating Sleeve and Tightening Screw)	1	_____	_____

2. INSTALLATION ACCESSORY

Precaution of installing the wire controller

1. This manual provides the installation method of wire controller. Please refer to the wiring diagram of this installation manual to wire the wire controller with indoor unit.
2. The wire controller working in low voltage loop circuit. Forbid to directly contact the cable of 220V commercial electricity or of 380V high voltage, and don't wire this kind of wire in the said loop; wiring clearance between configured tubes should be at the range of 11.8~19.7in or above.
3. The shielded wire of the wire controller must be grounded reliably.
4. Upon finishing the wire controller connection, do not use a tramegger to detect the insulation.
5. The connective cable of wire controller should not be longer than 65.62ft.

3. INSTALLATION METHOD

1. Wired remote controller structure size figure

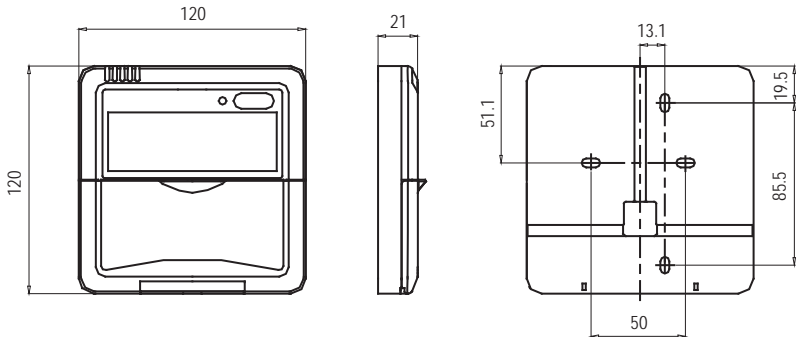

Fig 3-1

2. Wiring Principle Sketch:

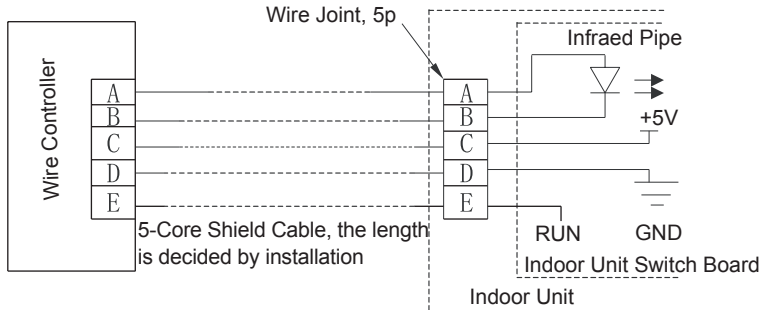

Fig 3-2

3. INSTALLATION METHOD

3. Wiring figure

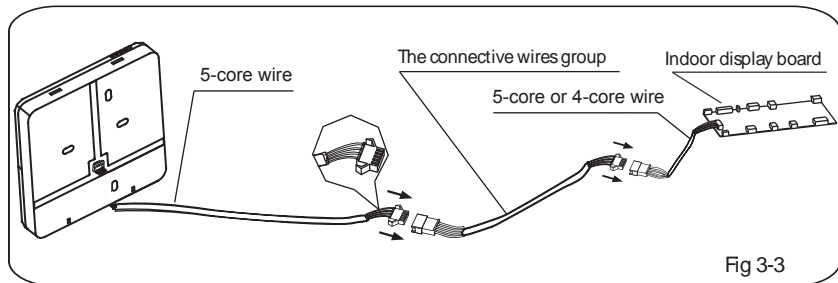

Fig 3-3

- Connect the female joint of wires group from the mainboard with the male joint of connective wires group. (See Fig.3-3)
- Please connect the other side of connective wires group with the male joint of wires group leads from wire controller. (See Fig.3-3)

4. Remove the upper part of wire controller

- Insert a slot screwdriver into the slots in the lower part of the wire controller (2 places), and remove the upper part of the wire controller. (Fig.3-4)



NOTICE

The PCB is mounted in the upper part of the wire controller. Be careful not to damage the board with the slot screwdriver.

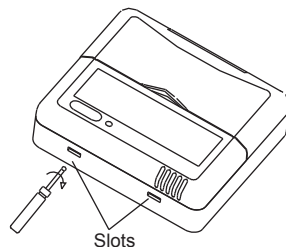
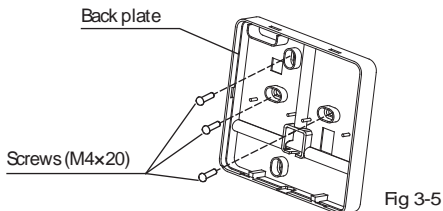

Fig 3-4

3. INSTALLATION METHOD

4. Fasten the back plate of the wire controller

- For exposed mounting, fasten the back plate on the wall with the 3 screws (M4x20) and plugs. (Fig.3-5)



- For flush-mounting, fasten the back plate on the switch box with 2 screws (M4x25) and fasten it on the wall with 1 screw (M4x20). (Fig.3-6)

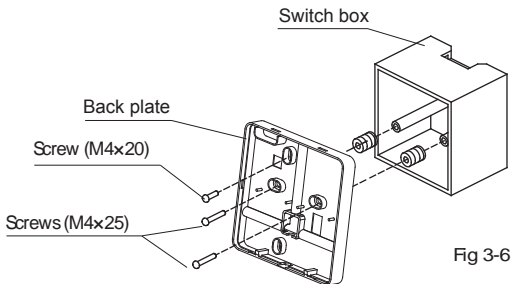

NOTICE

Put on a flat surface. Be careful not to distort the back plate of the wire controller by overtightening the mounting screws.

3. INSTALLATION METHOD

5. Wiring

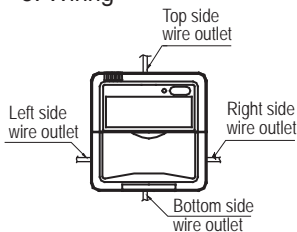

A. For exposed mounting, four outletting positions. There are three need cutting.

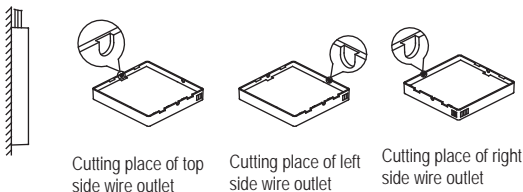
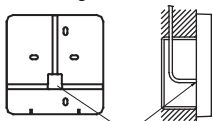

Fig 3-7

B. Shielded wiring

Embedded switch box wiring



Wiring through the wall

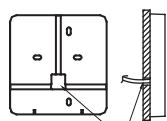

Fig 3-8

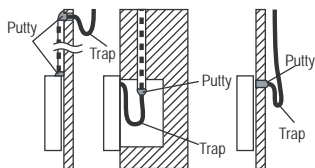

Fig 3-9



CAUTION

Avoid the water enter into the wired remote controller, use trap and putty to seal the connectors of wires during wiring installation. (Fig.3-9)

When under installation, reserve certain length of the connecting wire for convenient to take down the wired remote controller while during maintenance.

3. INSTALLATION METHOD

6.Reattach the upper part of the wire controller

- After adjusting the upper case and then buckle the upper case; avoid clamping the wiring during installation. (Fig 3-10)

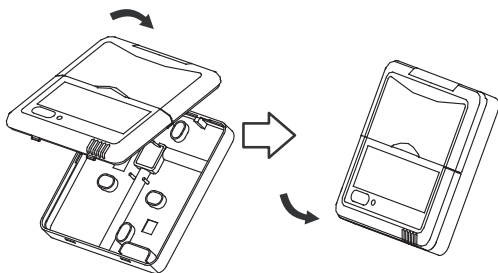

Fig 3-10

All the pictures in this manual are for explanation purpose only.
Your wire controller may vary.



Olympus Series

Mid-Static Duct Air Handler
(9K, 12K, 18K, 24K & 48K Models)

The design and specifications are subject to change without prior notice.
Consult with the sales agency or manufacturer for details.